

INSTALLATION DETAILS

Installation Details for Code Compliance

- Must be installed per manufacturer's instructions
- Architects can provide construction details for plan approval
 - [TER No. 1205-05](#)
 - Provides path for code compliance and approval
 - DXF files also available. Contact Staff.

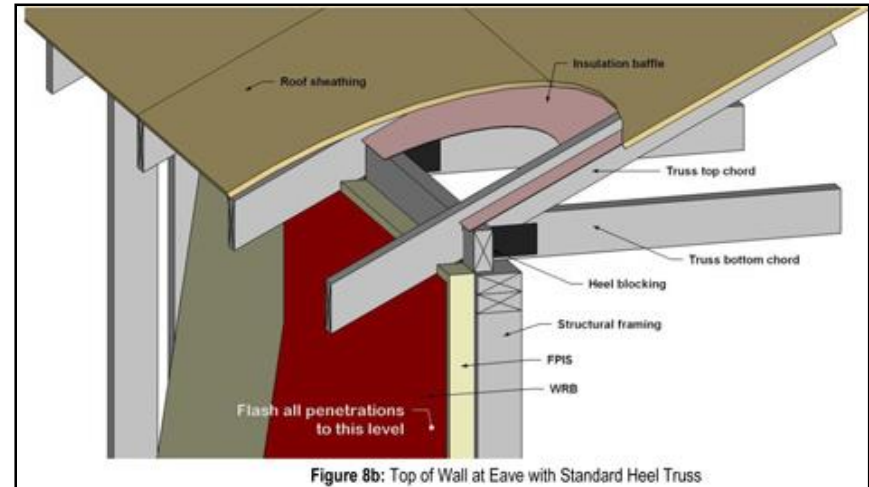

Figure 8b: Top of Wall at Eave with Standard Heel Truss

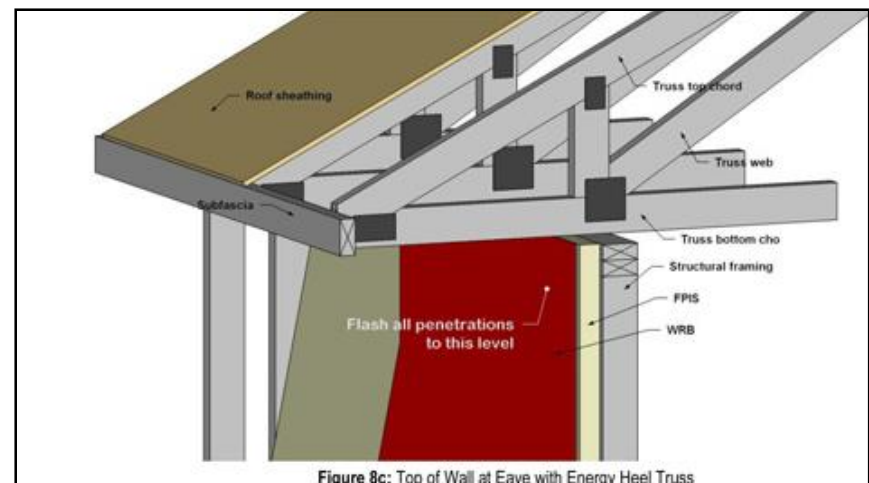

Figure 8c: Top of Wall at Eave with Energy Heel Truss

Window and Siding Installation Details with Thick Foam

- Detailing of CI wall assemblies with 6"+ of foam
 - DOE's Building America Program
 - Alaska REMOTE house
 - Passivhaus design
 - Net-zero buildings
- [TER No. 1304-01](#) (limited to 2" FPIS)



Image 2.4: Extension Jamb attached directly to a window



Detailing Tips

- If no more than 2" of CI on a 2x4 wall
 - Total wall thickness for window and door frames is no different than 2x6 construction
 - $3.5" + 2" = 5.5"$
- For thicker applications of CI:
 - May need to “box out” window and door openings
 - Corner/trim details required
 - Furring can provide siding attachment and positive securement